

# Park Model RV's

Perfect For Vacation Homes & Campgrounds



*Shown with traditional blend Vinyl Shake Siding, Clay Windows and Bronze Metal Roof.*

Custom Built by:

**Rocky Mountain**  
• STRUCTURES LLC •

Lykens, PA [www.rockymtnsheds.com](http://www.rockymtnsheds.com)



*Peaceful, Relaxing, Affordable ...  
... the Lodge*

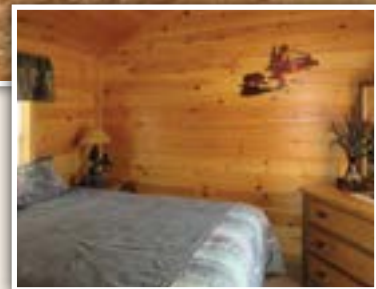

**RUSTIC STYLING WITH MODERN CONVENIENCES.**





# INDEX

**Lehigh Series ... 4**



**Pocono Series ... 6**



**Keystone Series ... 8**





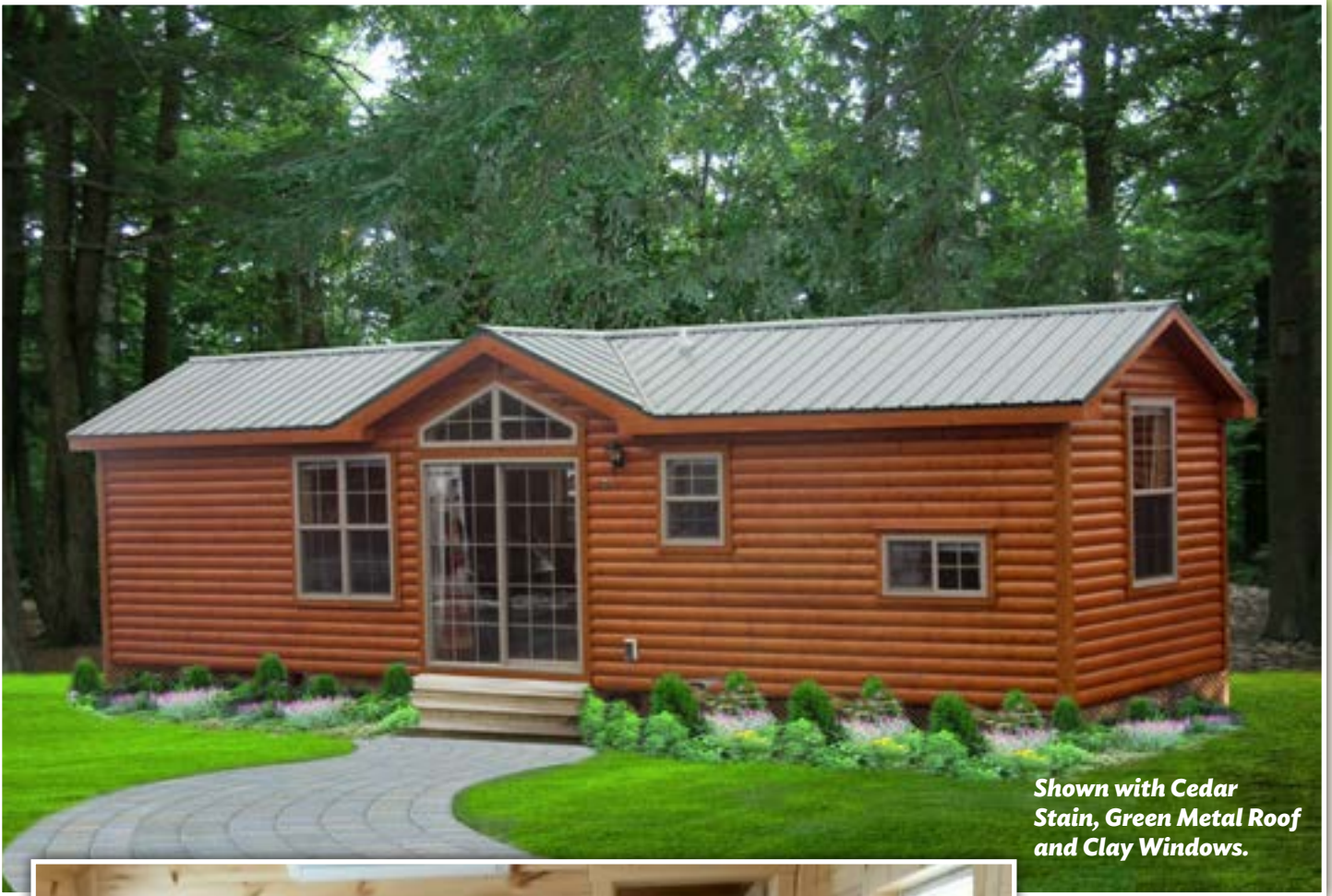

**Shown with Cedar Stain, Green Metal Roof and Clay Windows.**



*CHOOSE A FLOOR PLAN that best suits your needs and add the options you like to make your weekend get-a-way a special place to relax with your family and friends.*

# Lehigh Series

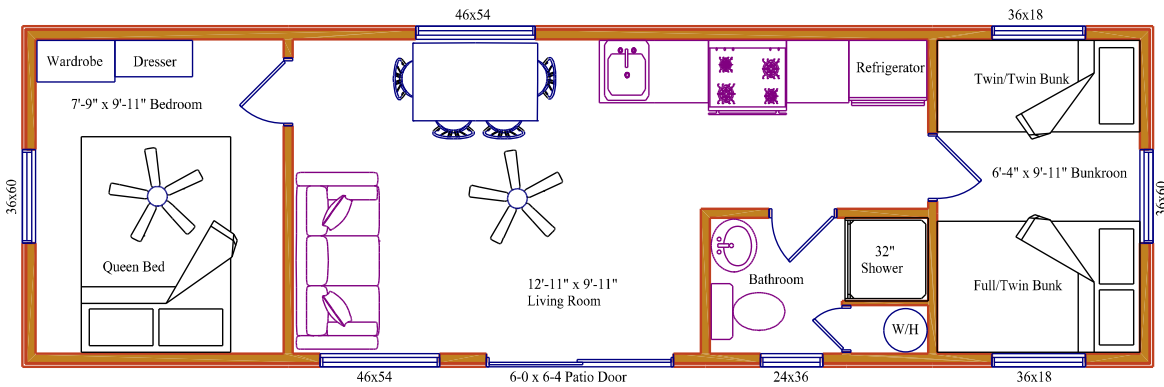

**Model L36** – Size: 10'-8" x 36', 2 Bedroom

## Additional Floor Plans

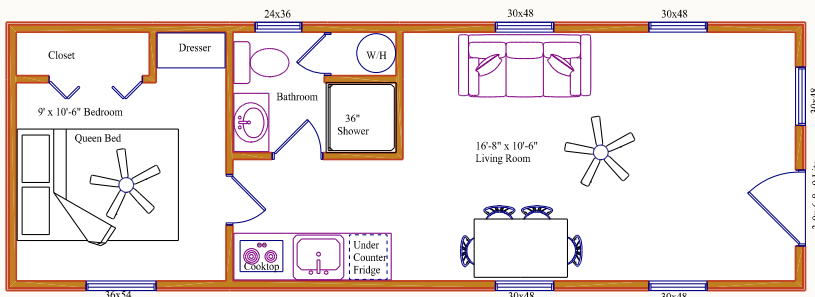

**Model L34** – Size: 11'-3" x 34', 1 Bedroom

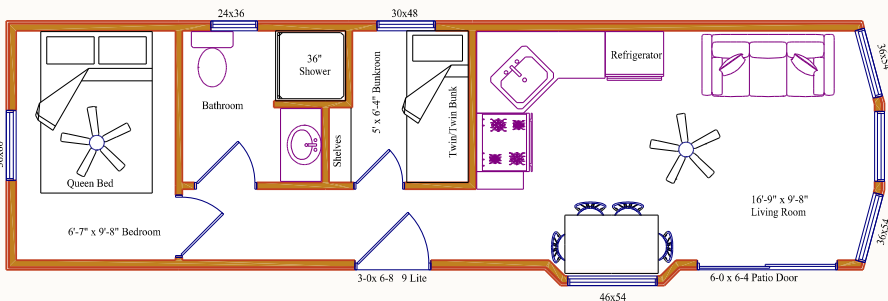

**Model L37** – Size: 10'-5" x 37', 2 Bedroom, Bay Window

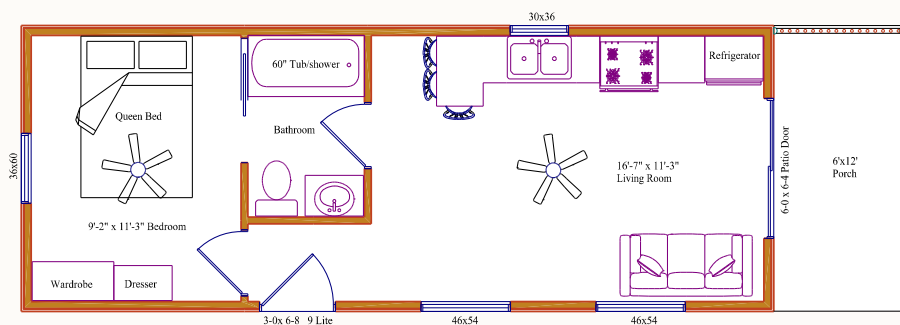

**Model L38** – Size: 12' x 32', 1 Bedroom with 6' porch

*Pick from one of our floor plans or bring your ideas and we will customize a floor plan to your specifications.*

**The Lehigh Series**  
*Come without a loft and are available in 1 or two bedrooms. Reversed gables and bumpouts are optional.*

*All Park Model RV's are limited to 400 square feet. Porches are not calculated in the 400 square feet and can be any size.*





**Shown with Sikkens® Cedar Stain, Burgundy Metal Roof and Clay Windows.**



*Standard with 52" Rustic Fan/Light in Living Room and Bedroom.*



*Loft Stairs come with hand rail.*

*A PLACE TO UNWIND, reconnect with your family and friends, and spend some quiet moments renewing your relationship with the Lord. Our knotty pine interiors are warm and healing to the soul.*

# Pocono Series

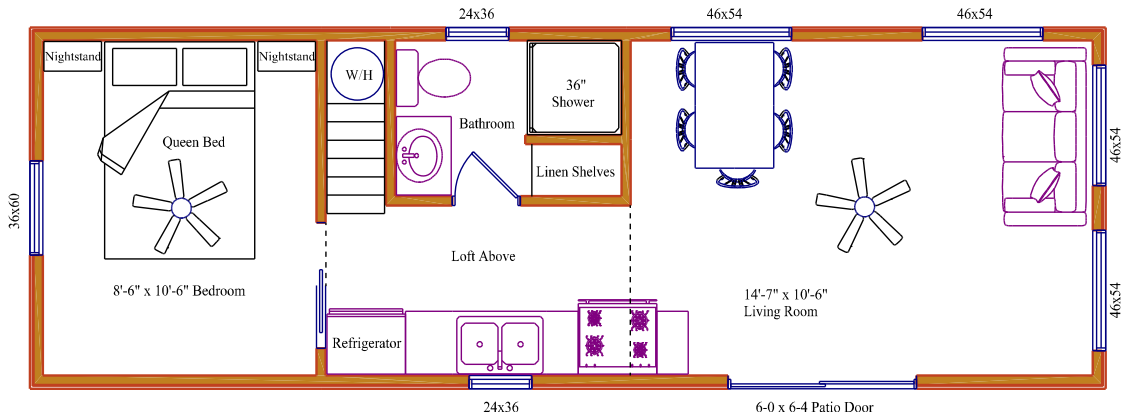

**Model P34** – Size: 11'-3" x 34', 1 Bedroom, Loft

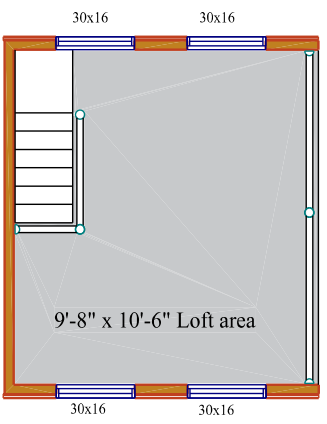

Loft Plan

## Additional Floor Plans

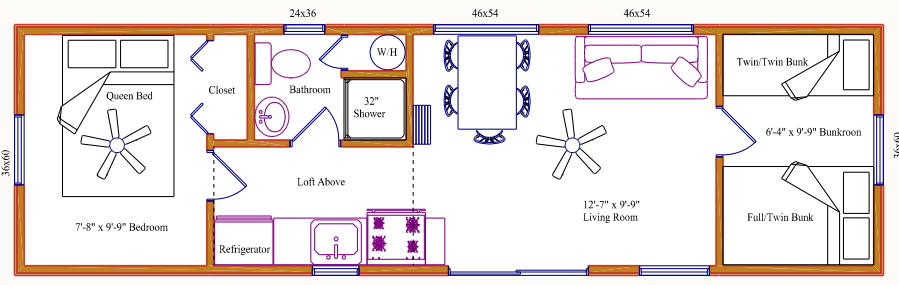

**Model P37** – Size: 10'-6" x 37', 2 Bedroom, Loft

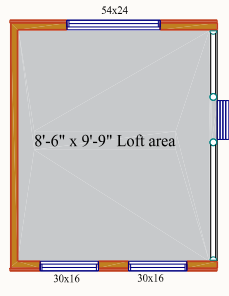

Loft Plan

**The Pocono Series**  
 Come with a loft which provide extra room for the children to play or simply use as a spare storage room. Access with stairs or removable ladder.





**Shown with Clay Vinyl Siding, Brown Metal Roof and Clay Windows.**



*RELATIONSHIPS created at the PARK can last forever, generation after generation of your family can have great memories to cherish.*



# Keystone Series

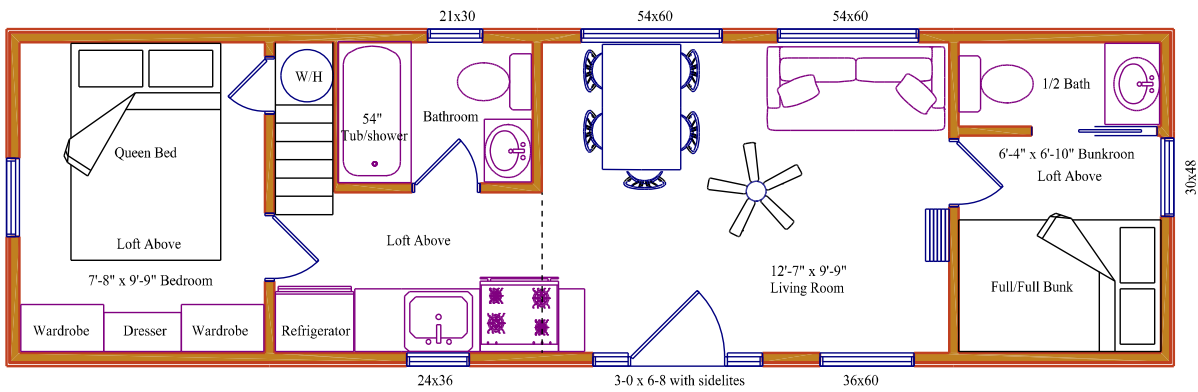

**Model K37** – Size: 10'-6" x 37', 2 Bedroom, 1-½ Bath, Double Loft

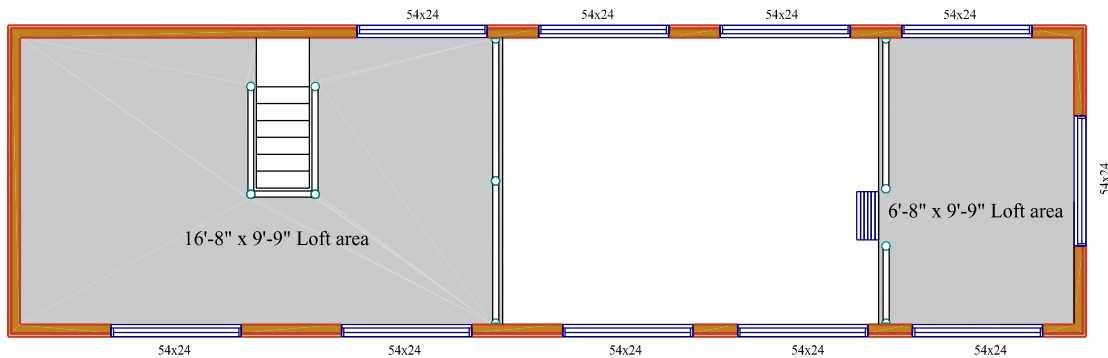

Loft Plan

*Maximize your square footage with lofts.*

## Additional Floor Plans

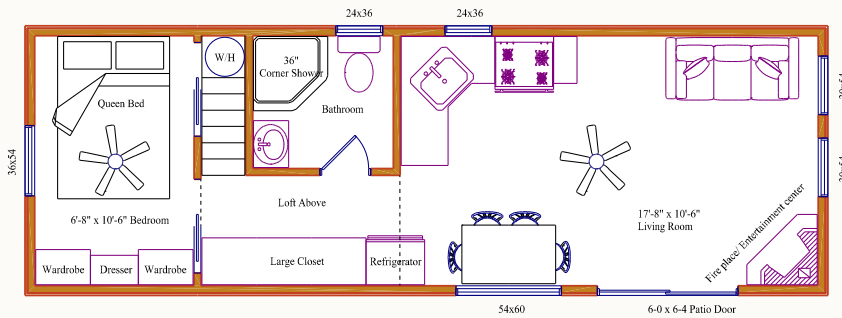

**Model K34** – Size: 11'-3" x 34', 1 Bedroom, Loft

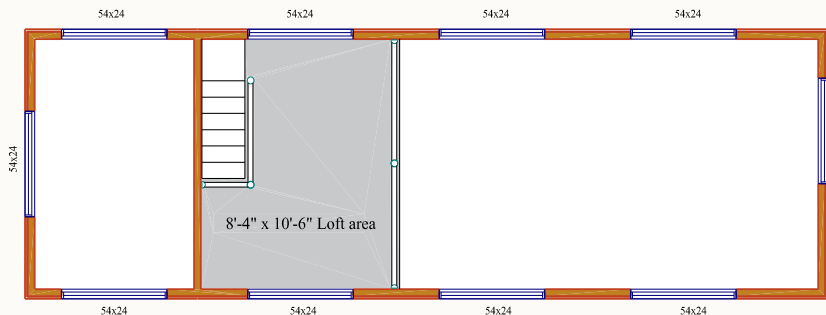

Loft Plan

**Keystone Series**  
Come with 10' high walls, available with a single, double or triple loft or choose wide open cathedral floor plan without any loft.

# CUSTOM PARK MODELS



Our Rocky Mountain Structures Team is dedicated to provide the highest quality and best service from design to installation!



## CONSTRUCTION STANDARDS

- Heavy Duty Steel Chassis with Outriggers and Detachable Hitch
- 2x6, 16" On Center Floor Joists
- 3/4" Sub Floor
- 2x4 Exterior Walls
- 7/16" OSB Wall Sheeting
- 50 lbs. Snow Load Roof System
- R-19 Floor and Roof Insulation
- Poly Board Underbelly
- R-13 Wall Insulation
- House Wrap
- 6" Roof Overhangs
- White Vinyl Thermo-Pane Windows (we use the American Craftsman line of Anderson windows)
- Sliding Glass Door or 9 Lite House Door
- Limited Lifetime Metal or Shingled Roof
- T&G Knotty Pine Interiors (Clear Finished)
- Solid Pine Raised Panel Interior Doors
- Woodgrain Vinyl Flooring
- Two 52" Ceiling Fans with Lights
- 20 Gallon Electric Water Heater
- Smoke Detectors
- Fire Extinguisher
- 50 Amp Electrical Service
- Two Cable Outlets
- 12,000 BTU Heat and Air Ductless Mini Split System
- Standard Loft Height 48"
- Choice of Stained #1 Log Siding or Premium Vinyl Dutch Lap Siding
- RVIA Seal

### KITCHEN STANDARD FEATURES:

- 10 ft. Length of Pine Cabinetry
- Under-Counter Refrigerator
- Two-Burner Electric Cook Top
- Space Saver Microwave

### BATHROOM STANDARD FEATURES:

- Shower
- Pedestal Sink
- Residential-Style Commode
- Linen Shelves
- Bath Exhaust Fan

**MANY OPTIONS AVAILABLE - CONTACT A DEALER FOR MORE DETAILS**

The pictures and illustrations in this literature show optional furnishings and upgrades.  
Due to continual product improvement, Rocky Mountain Structures LLC reserves the right to change specifications at any time and assumes no responsibility for any errors in this literature.



# Color Choices

## LOG SIDING STAIN COLORS

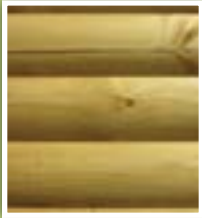

Natural Pine



Cedar



Redwood



Mushroom



Linden Leaf



Grey

## OIL STAIN COLORS

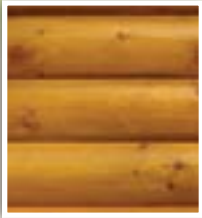

Sikkens® Cedar



Sikkens® Redwood



Drystack Stone

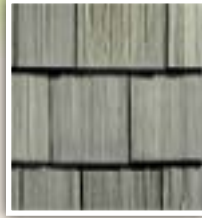

Khaki



Terra Clay

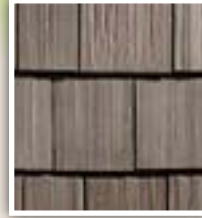

Traditional Blend

## STONE

## VINYL SHAKE COLORS

## MASTIC QUEST® VINYL SIDING COLORS

(Lifetime Limited Warranty)



American Walnut



English Wedgewood



Lakeshore Fern



Pebblestone Clay



Russet Red

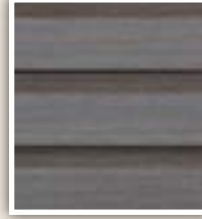

Timberstone

## EVERLAST® OMNI SERIES METAL ROOFING COLORS (Lifetime Limited Warranty)



Clay



Bronze



Brown



Ivy



Red



Burgundy

## TIMBERLINE ULTRA HD® SHINGLE COLORS

(Lifetime Limited Warranty)



Charcoal

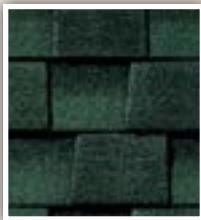

Hunter Green

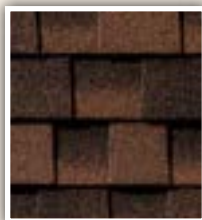

Hickory

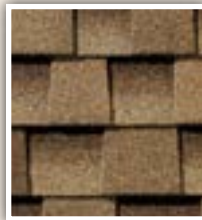

Shakewood



Weathered Wood



Fox Hollow Gray

# Serving Campgrounds, RV Parks, and More!

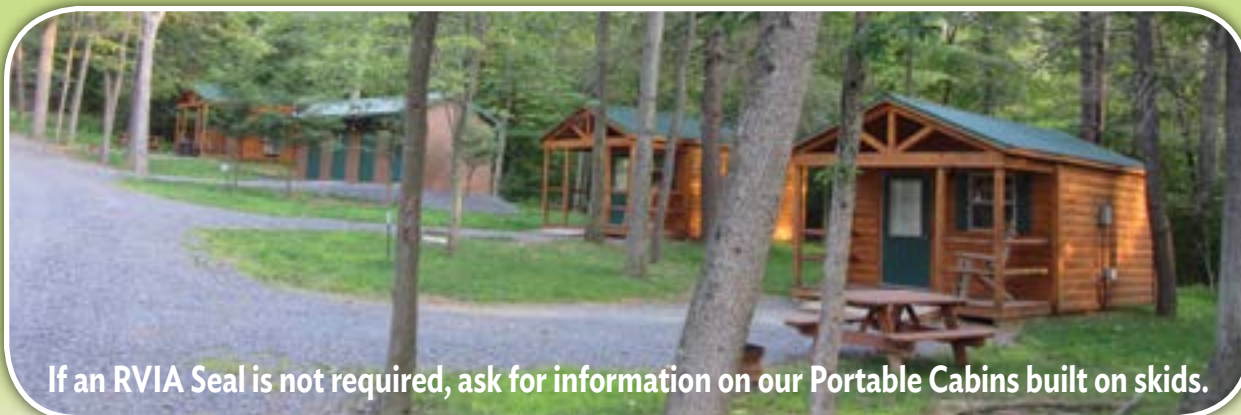

If an RVIA Seal is not required, ask for information on our Portable Cabins built on skids.



- Fully Assembled
- Many Options Available
- Competitive Pricing
- No Building Permits
- Classified as an RV
- No Real Estate Taxes



As a member of the Recreational Vehicle Industry Association, Rocky Mountain RV's, LLC meets or exceeds industry standards as part of our commitment to ensure our customers of the highest quality craftsmanship.

Authorized Park Model Dealer



*Civilized Camping away from home!*