

# CABINS

*for recreational use*  
**CAMPGROUND RENTALS & HUNTING GET-A-WAYS**



*Custom Built by:*

**Rocky Mountain**  
• STRUCTURES LLC •

Lykens, PA [www.rockymtnsheds.com](http://www.rockymtnsheds.com)

# *Retreat with all the*

**A Place To Unwind**, reconnect with your family and friends, and spend some quiet moments renewing your relationship with the Lord.

*Our Knotty Pine Interiors are warm and healing to the soul.*

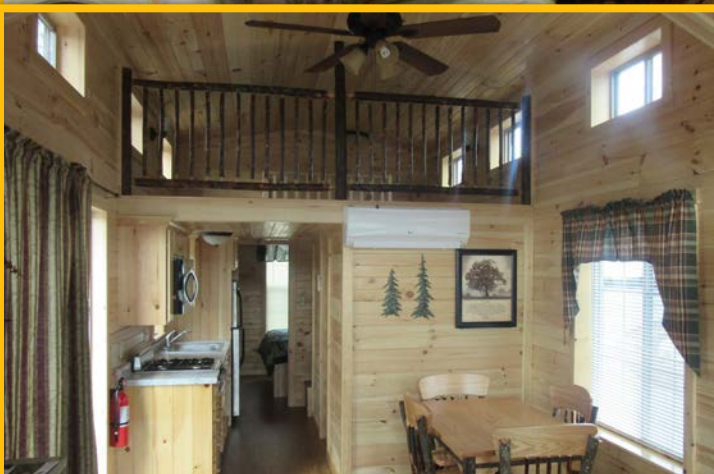

## **A HOME AWAY FROM HOME**

*All the details of life and the stress of work feel a million miles away.*

*Comforts...*

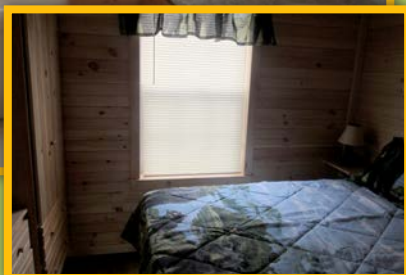

## INDEX



**GET-A-WAY** - Page 4



**MAHANTANGO** - Page 6



**DOUBLE WIDE** - Page 8



**CUSTOM CABINS** - Page 10

# GET-A-WAY CABINS

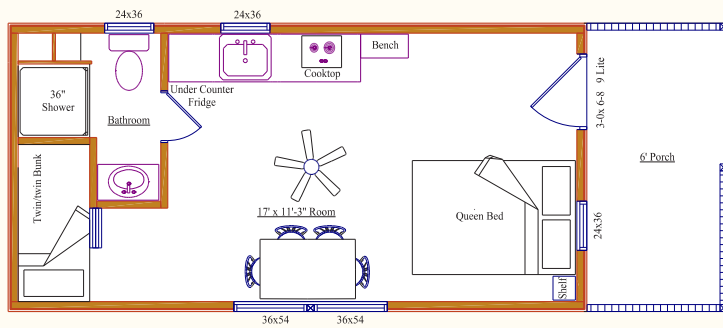

**Model CG30** 12' x 30'

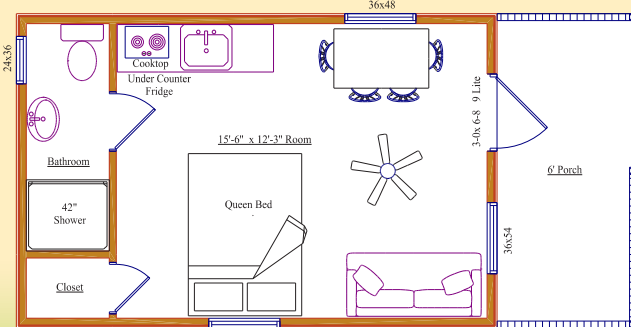

**Model CG26** 12' x 26'

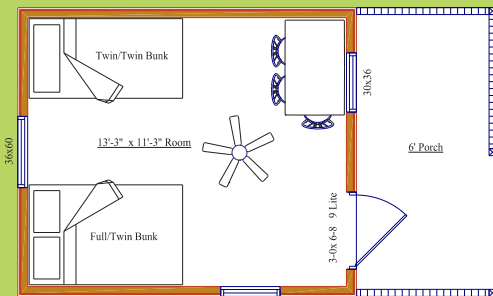

**Model CG20** 12' x 20'

**Creating memories that will last a lifetime ...**

*Where it's easy to toss your cares aside and enjoy every moment. Whether that means a day of activities, or a day of doing nothing at all.*

**RELATIONSHIPS** created at the Cabin can last forever. Generation after generation of your family may have great memories to cherish.



## ADDITIONAL MODELS

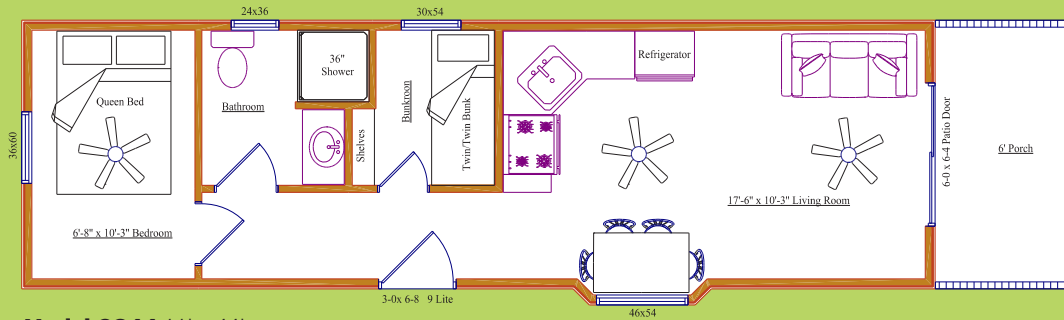

**Model CG44** 11' x 44'

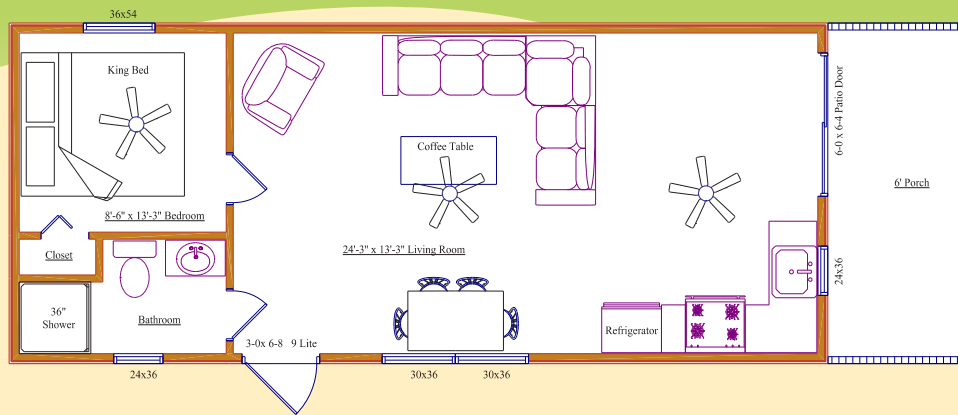

**Model CG40** 14' x 40'

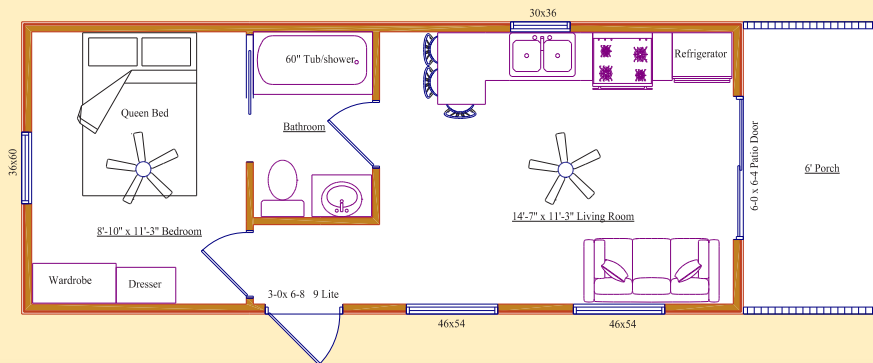

**Model CG36** 12' x 36'

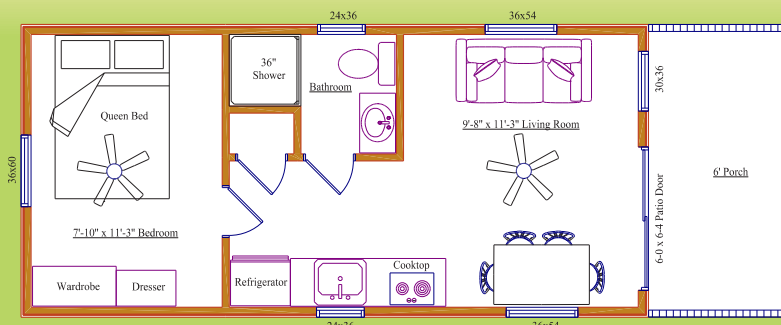

**Model CG32** 12' x 32'

Pick from one of our floor plans or bring your ideas and we will customize a floor plan to your specifications.

The Get-A-Way Cabin Series Comes standard with a 6' Cathedral Porch with optional loft above.

Available in one or two bedrooms.



# MAHANTANGO

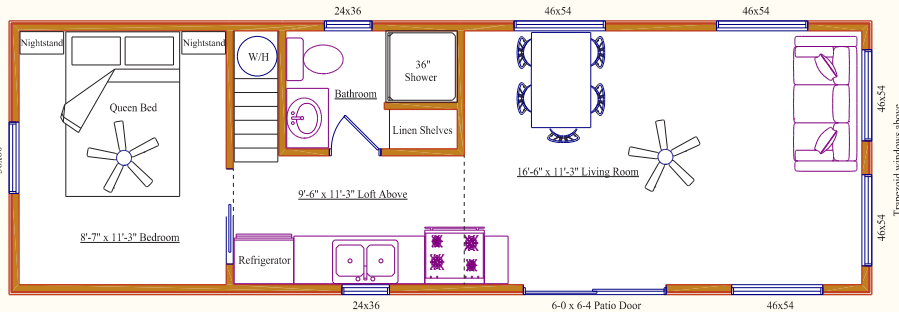

**Model CM36 12' x 36'**

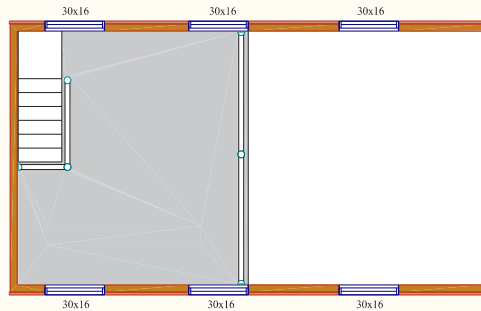

**Loft Plan**

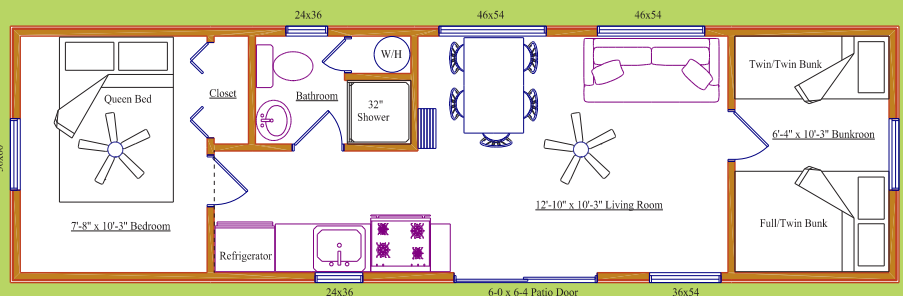

**Model CM37 11' x 37' 2-Bedrooms**

## ADDITIONAL MODELS

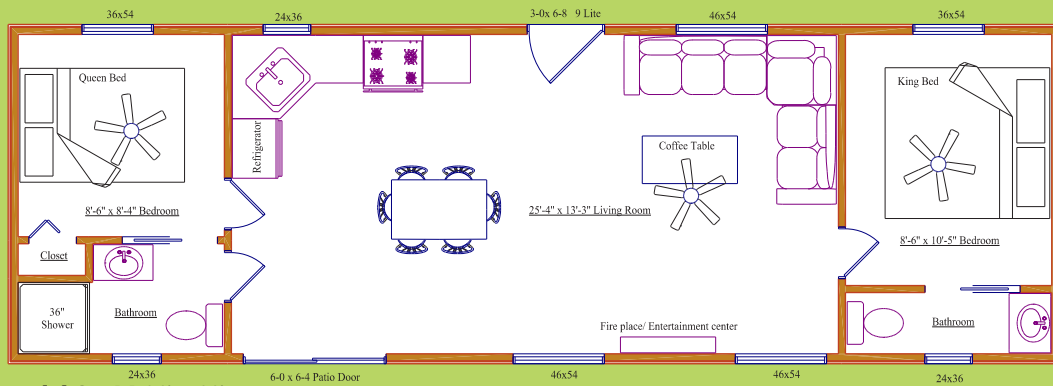

**Model CM44** 14' x 44'

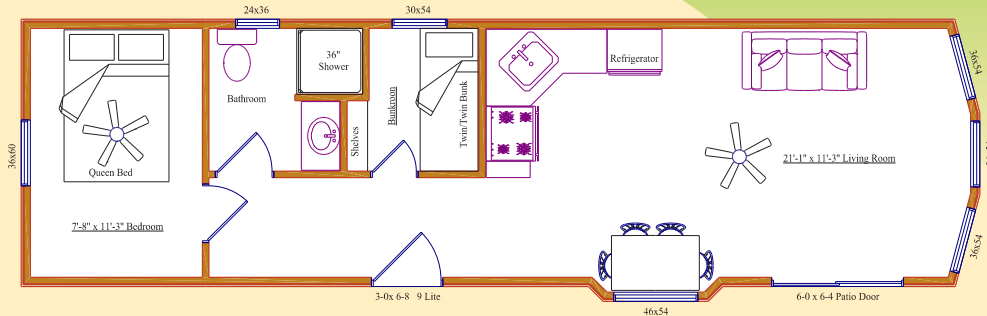

**Model CM40** 12' x 40'

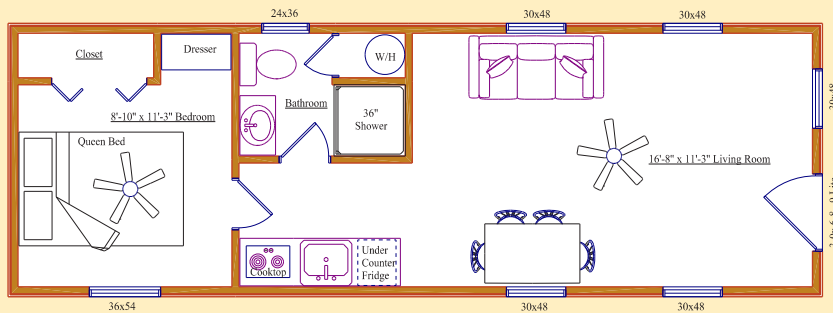

**Model CM34** 12' x 34'

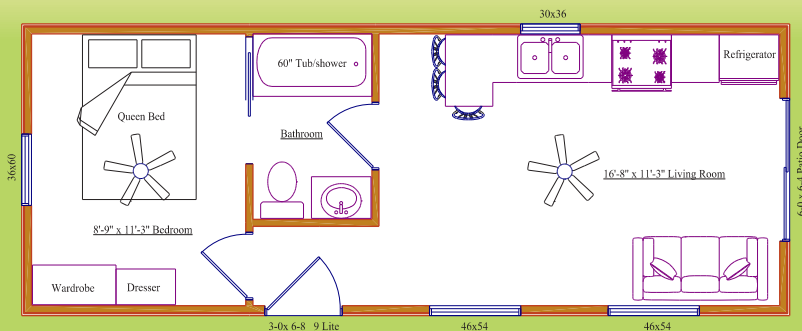

**Model CM32** 12' x 32'

Plenty of lights and outlets let you stay plugged in. Large windows let you enjoy nature's beauty without stepping outside. With your own Cabin you won't have the hassle and expense of hauling an RV or other bulky equipment around.

The Mahantango is available in one or two bedrooms. Lofts are optional and will provide extra room for the children to play and sleep or extra storage space.



# DOUBLE WIDE CABINS

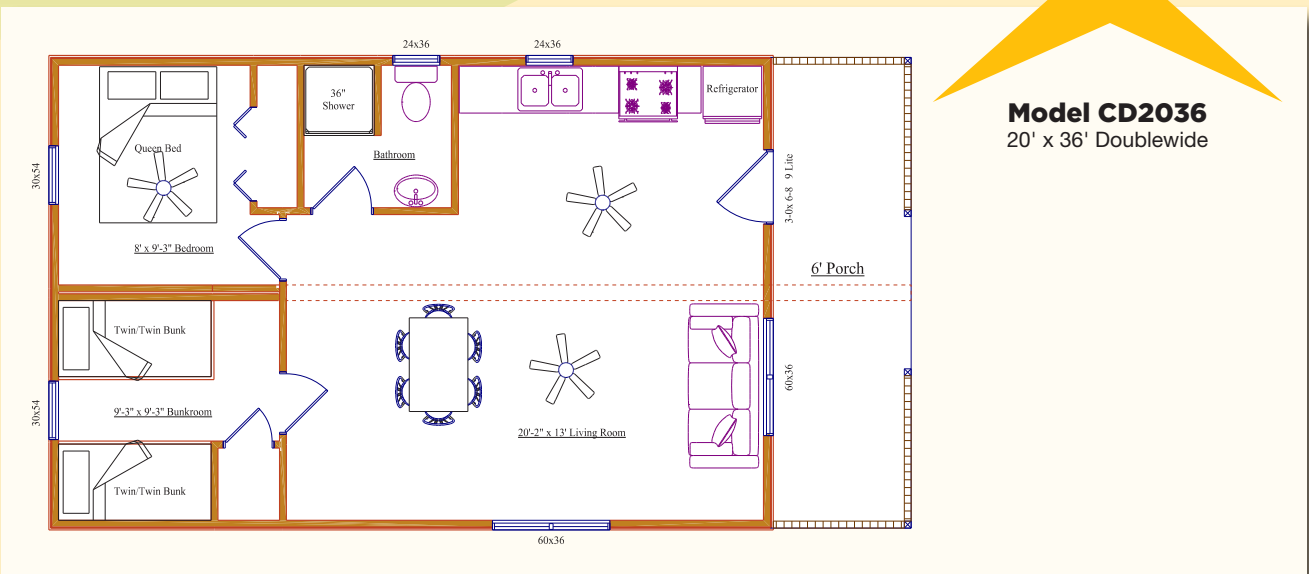

**Model CD2036**  
20' x 36' Doublewide

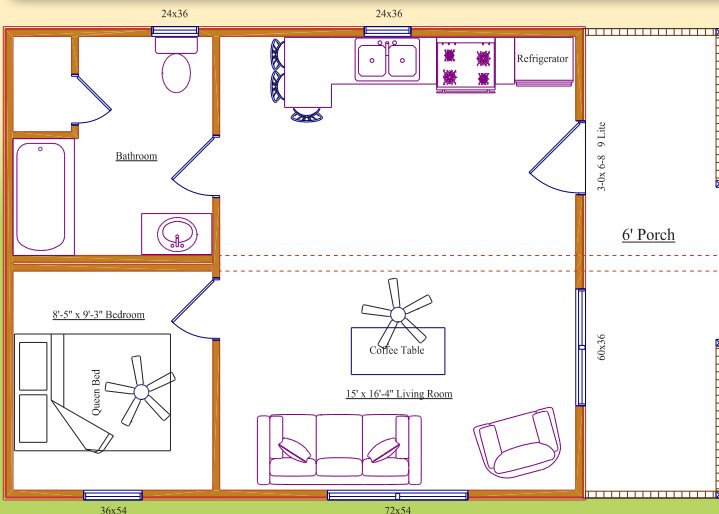

**Model CD2030** 20' x 30' Doublewide

Our Double Wide Cabins will accommodate larger groups and make great vacation homes.

We can also customize for full time living.

Crane setting on full basements is available.



## ADDITIONAL MODELS

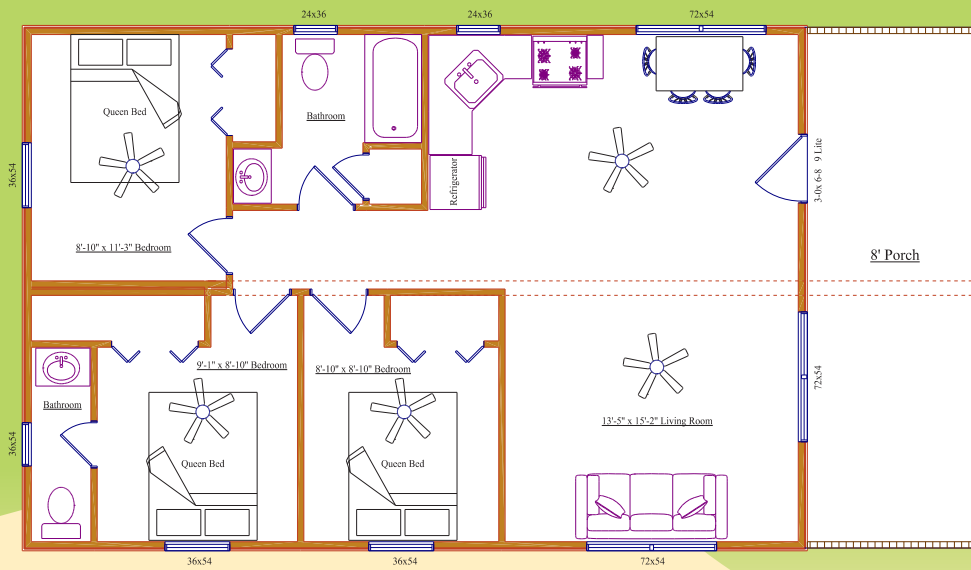

**Model CD2444** 24' x 44' Doublewide

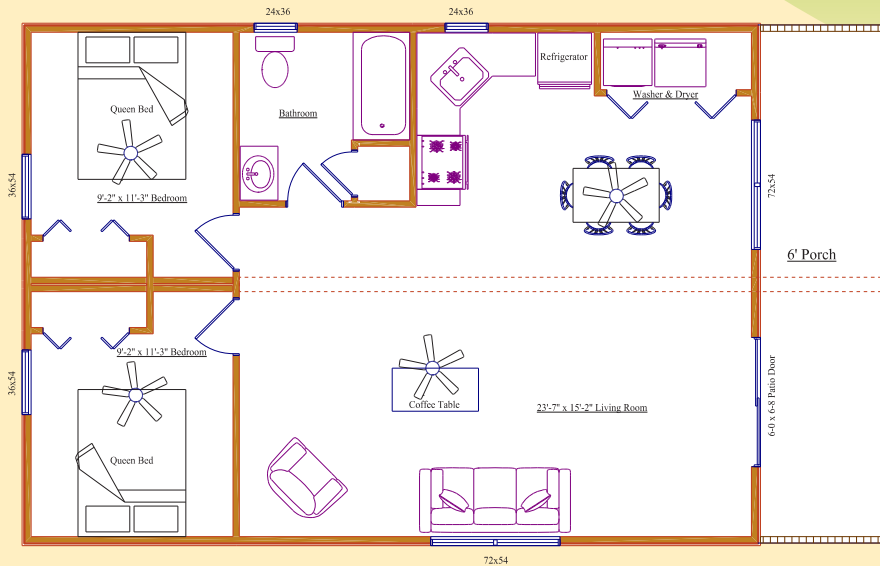

**Model CD2440** 24' x 40' Doublewide

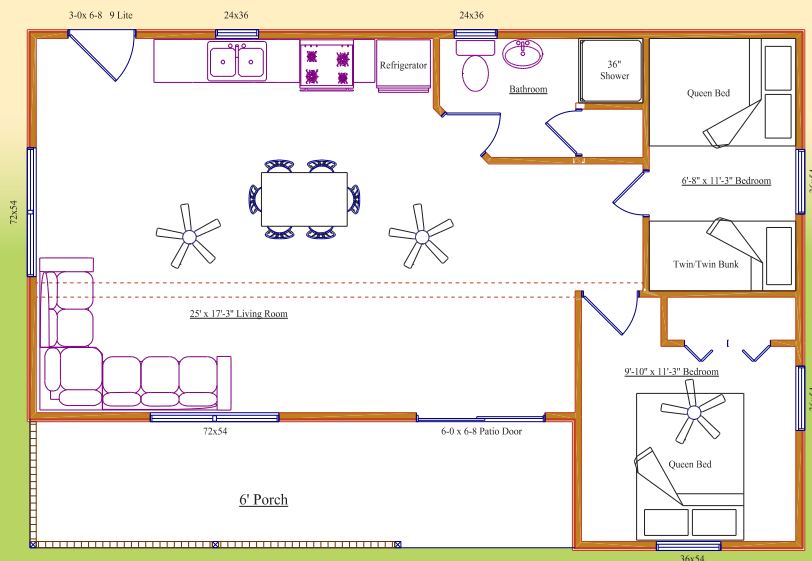

**Model CD2436** 24' x 36' Doublewide

These Rustic Cabins are right at home in any natural setting.

They are manufactured in a climate controlled facility with better quality control. Built extra sturdy to withstand transporting.

Standard with cathedral ceilings, 2 or 3 bedrooms, 1 or 2 bathrooms

We are committed to building your Cabin the way you want it.



# CUSTOM CABINS



Our Rocky Mountain Structures Team is dedicated to provide the highest quality and best service from design to installation!



## CONSTRUCTION STANDARDS

- 4x4 Pressure-Treated Skids
- 2x6, 16" OC Pressure-Treated Floor Joists
- 3/4" Sub Floor
- 2x4 Exterior Walls
- 7/16" OSB Wall Sheeting
- 50 lbs. Snow Load Roof System
- R-19 Floor and Roof Insulation
- Galvanized Metal Bottom
- R-13 Wall Insulation
- House Wrap
- 6" Roof Overhangs
- White Vinyl Thermo-Pane Windows
- White 9-Lite Fiberglass Entrance Door

- Sliding Patio Door
- Limited Lifetime Metal or Shingled Roof
- T&G Knotty Pine Interiors (Clear Finished - 2 Coats)
- Solid Pine Raised Panel Interior Doors
- Woodgrain Vinyl Flooring
- Two 52" Ceiling Fans with Lights
- 20 Gallon Electric Water Heater
- Smoke Detectors
- Fire Extinguisher
- 50 Amp Electrical Service
- Two Cable Outlets
- 110V Heat and Air 8500 BTU

- Standard Loft Height 36"
- Choice of Stained #1 Log Siding or Premium Vinyl Dutch Lap Siding

### KITCHEN STANDARD FEATURES:

- 10 ft. Length of Pine Cabinetry
- Under-Counter Refrigerator
- Two-Burner Electric Cook Top
- Space Saver Microwave

### BATHROOM STANDARD FEATURES:

- Shower
- Pedestal Sink
- Residential-Style Commode
- Linen Shelves
- Bath Exhaust Fan

**MANY OPTIONS AVAILABLE**

# COLOR CHOICES

## LOG SIDING STAIN COLORS

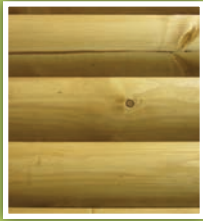

Natural Pine

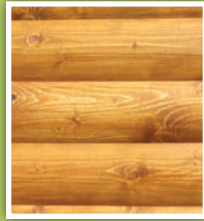

Cedar

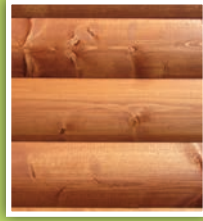

Redwood

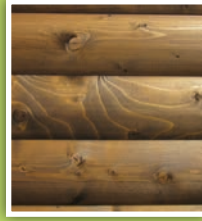

Mushroom

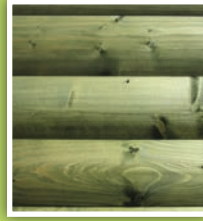

Linden Leaf

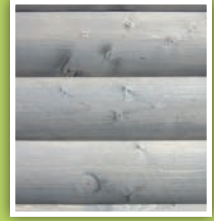

Grey

## OIL STAIN COLORS STONE

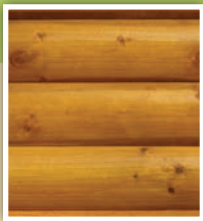

Sikkens® Cedar



Sikkens® Redwood



Drystack Stone

## VINYL SHAKE COLORS

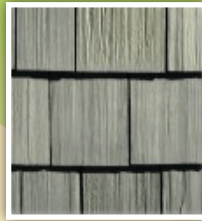

Khaki



Terra Clay

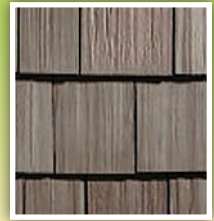

Traditional Blend

## MASTIC QUEST® VINYL SIDING COLORS

(Lifetime Limited Warranty)



American Walnut



English Wedgewood



Lakeshore Fern



Pebblestone Clay



Russet Red



Timberstone

## EVERLAST® OMNI SERIES METAL ROOFING COLORS (Lifetime Limited Warranty)



Clay



Bronze

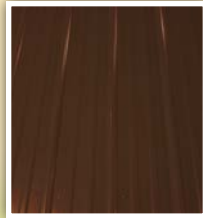

Brown

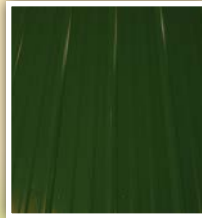

Ivy



Red



Burgundy

## TIMBERLINE ULTRA HD® SHINGLE COLORS

(Lifetime Limited Warranty)



Charcoal



Hunter Green



Hickory



Shakewood



Weathered Wood



Fox Hollow Gray

## SERVING CAMPGROUNDS, RV PARKS, AND MORE!



If an RVIA Seal is required, ask for information on our Park Models built on Trailer Frames.

- Fully Assembled
- Portable, Built on Skids
- Competitive Pricing
- Many Options Available
- Utilities Ready for Hook-up
- Add Value to your Property

Authorized Cabin Dealer



*Civilized Camping away from home!*